

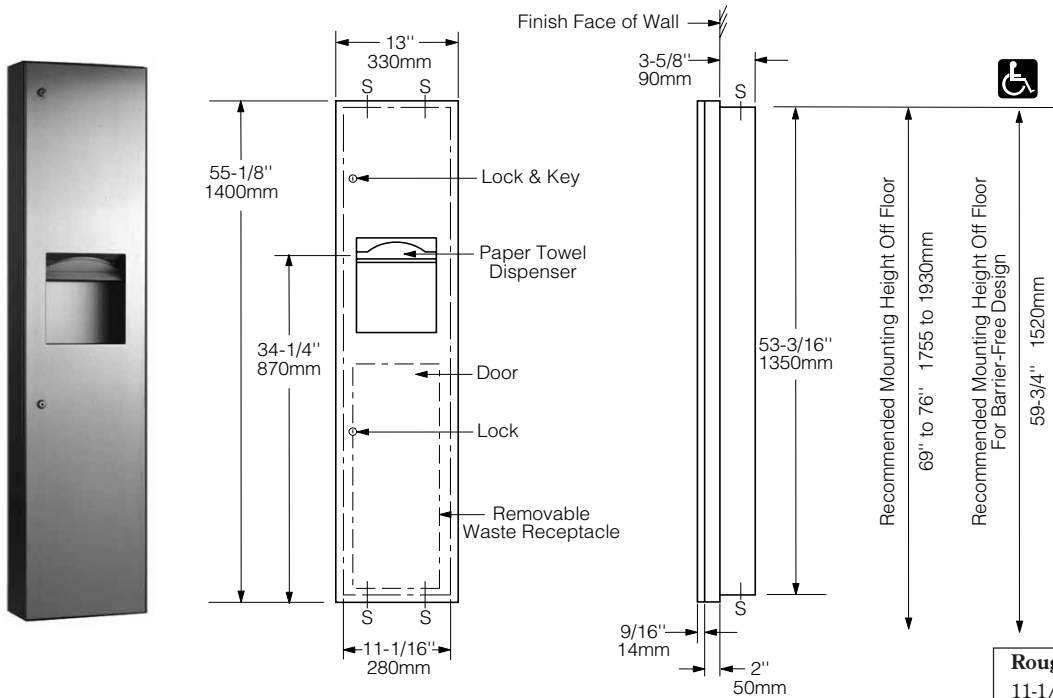

Technical Data

SEMI-RECESSED PAPER TOWEL DISPENSER AND WASTE RECEPTACLE

B-38032



Rough Wall Opening
11-1/2" (290mm) wide
53-5/8" (1360mm) high
3-3/4" (95mm) minimum recessed depth

MATERIALS:

Cabinet — 18-8 S, type-304, heavy-gauge stainless steel. All-welded construction.

Door — 18-8 S, type-304, 18-gauge (1.2mm) stainless steel with satin finish. 9/16" (14mm) 90° return for maximum rigidity. Secured to cabinet with a concealed, full-length, stainless steel piano-hinge. Equipped with stainless steel cable door-swing limiter and two tumbler locks keyed like other Bobrick washroom accessories.

Skirt — 18-8 S, type-304, 22-gauge (0.8mm) stainless steel with satin finish.

Paper Towel Dispenser — 18-8 S, type-304, 22-gauge (0.8mm) stainless steel with satin finish. Capacity: 600 C-fold, 800 multifold, or 1100 singlefold paper towels.

Waste Container — Leakproof, rigid molded plastic. Removable for servicing. Capacity: 6.3 gal. (24 L).

OPERATION:

Paper towel dispenser is adjustable to dispense C-fold, multifold, or singlefold paper towels without use of additional adapters or towel trays. To service waste receptacle, unlock door with key provided and remove waste container. Cable door-swing limiter prevents damage to washroom accessories and walls.

INSTALLATION:

Provide framed rough wall opening 11-1/2" wide x 53-5/8" high (290 x 1360mm). Minimum recessed depth required from finish face of wall is 3-3/4" (95mm). Allow clearance for construction features that may protrude into rough wall opening from opposite wall. If unit projects above top of wainscot, provide aluminum channel or other filler to eliminate gap between flange and finish face of wall. Mount cabinet with shims between framing and cabinet at all points indicated by an S, then secure unit with #8 x 1-1/4" (4.2 x 32mm) sheet-metal screws (not furnished).

SPECIFICATION:

Semi-recessed paper towel dispenser and waste receptacle shall be type-304 stainless steel; all-welded construction. Exposed surfaces shall have satin finish. Door with 9/16" (14mm) 90° return shall be secured to cabinet with a concealed, full-length, stainless steel piano-hinge and equipped with a stainless steel cable door-swing limiter and two tumbler locks. Paper towel dispenser shall be capable of dispensing 600 C-fold, 800 multifold, or 1100 singlefold paper towels. Waste receptacle shall be furnished with a removable, leakproof, rigid molded plastic waste-container with a capacity of 6.3 gal. (24 L). Manufacturer's service and parts manual shall be provided to the building owner/manager upon completion of project.

Semi-Recessed Paper Towel Dispenser And Waste Receptacle shall be Model B-38032 of Bobrick Washroom Equipment, Inc., Clifton Park, New York; Jackson Tennessee; Los Angeles, California; Bobrick Washroom Equipment Company, Scarborough Ontario; Bobrick Washroom Equipment Pty. Ltd., Australia; and Bobrick Washroom Equipment Limited, United Kingdom.